

# Custom made collets

Technical Data for special collets with short nose

## Sketch for special collets with short nose

(please fill in/complete)

Company : \_\_\_\_\_  
 \_\_\_\_\_

Sketch for :

☐

Enquiry

☐

Purchase order

Qty :

Collet type :

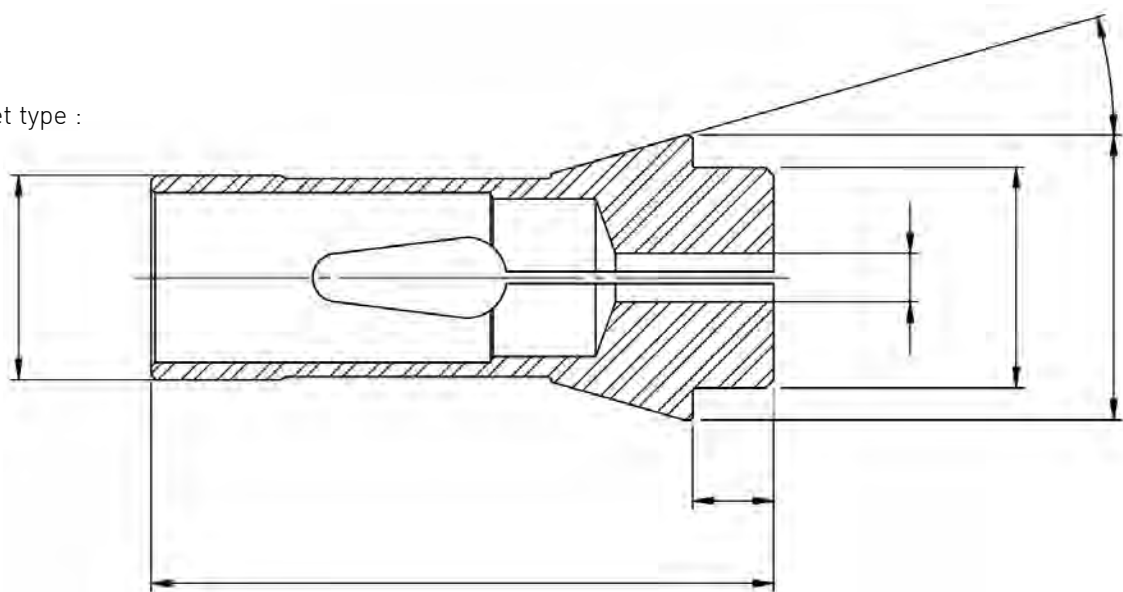
☐

Steel

☐

Carbide bore

☐

with key way on shank

☐

with key way on conus

☐

CuBe

☐

Phenol

☐

Croco

☐

-3 mm in the back

☐

with extractor

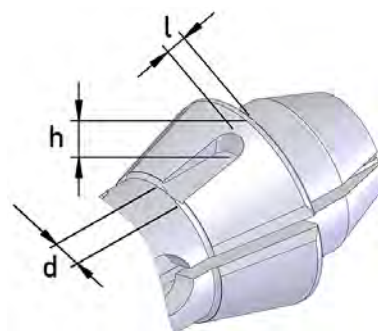
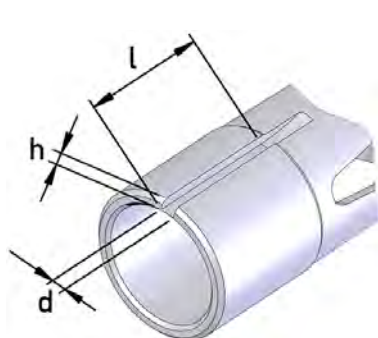

Notes : \_\_\_\_\_

\_\_\_\_\_  
 \_\_\_\_\_

# Custom made collets

## Technical Data for special collets with long nose

### Sketch for special collet with long nose (please fill in/complete)

Company : \_\_\_\_\_  
\_\_\_\_\_

Sketch for :

☐

Enquiry

☐

Purchase order

Qty :

Collet type :

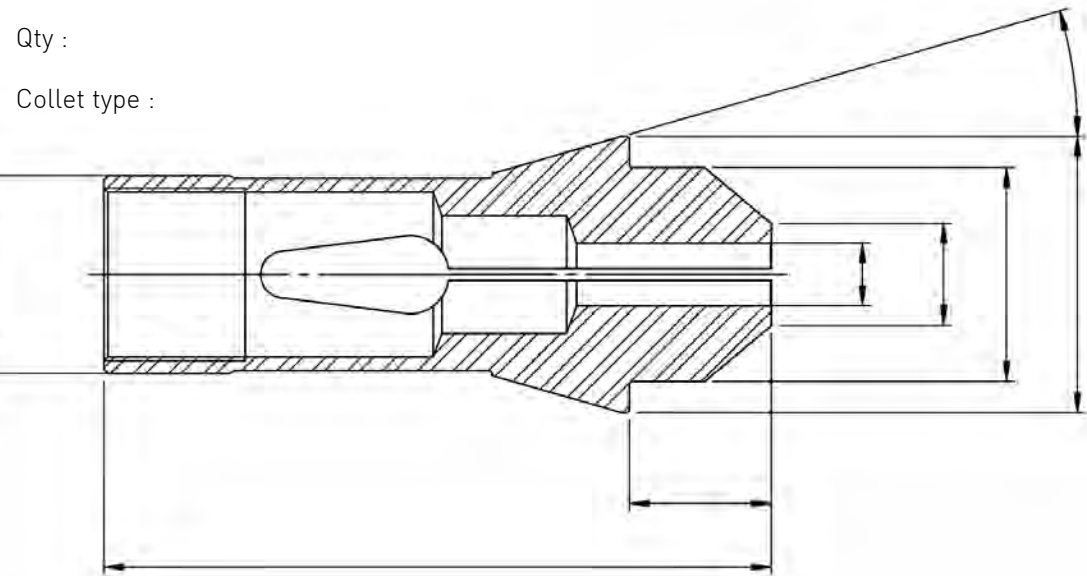
☐

Steel

☐

Carbide bore

☐

with key way on shank

☐

with key way on conus

☐

CuBe

☐

Phenol

☐

Croco

☐

-3 mm in the back

☐

with extractor

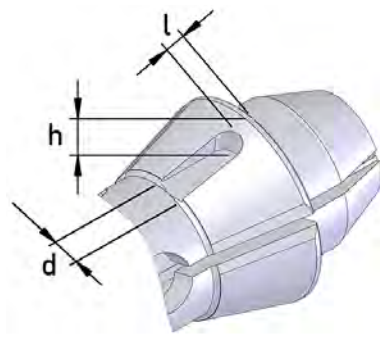
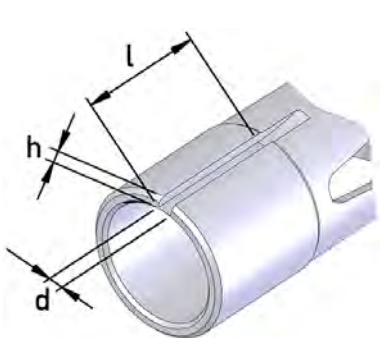

Notes : \_\_\_\_\_  
\_\_\_\_\_  
\_\_\_\_\_

# Custom made collets

## Special executions

Fig. 1

1 step bore

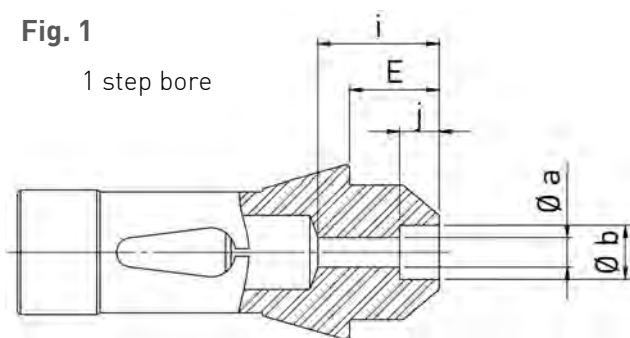

Fig. 2

2 step bore

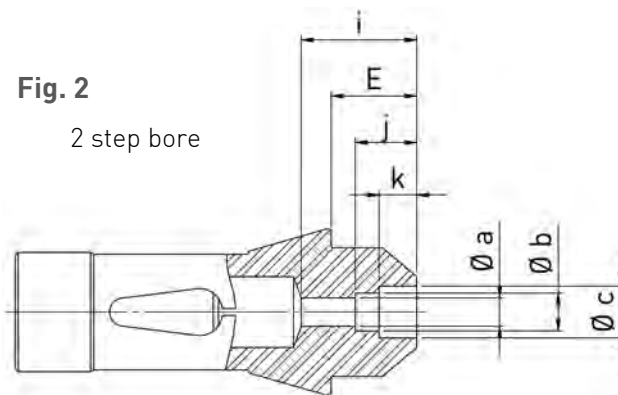

Fig. 3

special form with radius

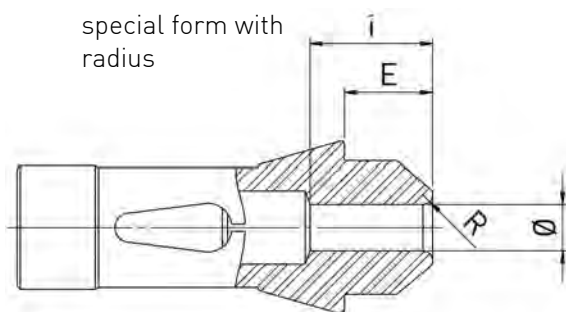
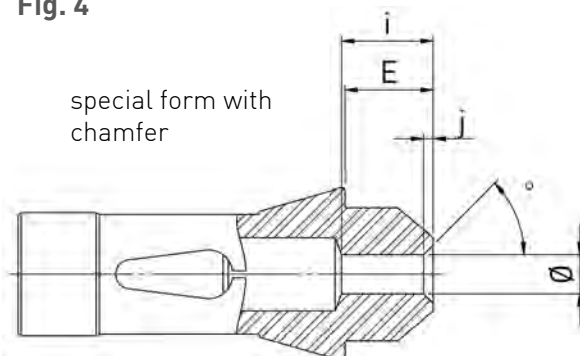

Fig. 4

special form with chamfer



Short nose



with key way on shank



with key way on conus



Long nose



Steel



Carbide bore

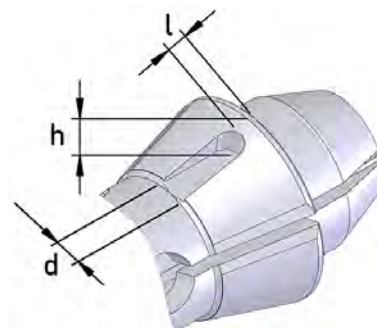
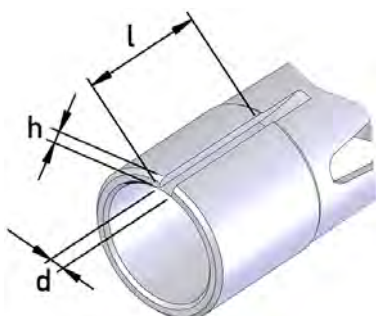

Fig. n°



Ø = \_\_\_\_\_

k = \_\_\_\_\_

Ø a = \_\_\_\_\_

° = \_\_\_\_\_

Collet type :

Ø b = \_\_\_\_\_

R = \_\_\_\_\_

Qty :

Ø c = \_\_\_\_\_

l = \_\_\_\_\_

E = \_\_\_\_\_

h = \_\_\_\_\_

i = \_\_\_\_\_

d = \_\_\_\_\_

j = \_\_\_\_\_

# Custom made collets

Special executions

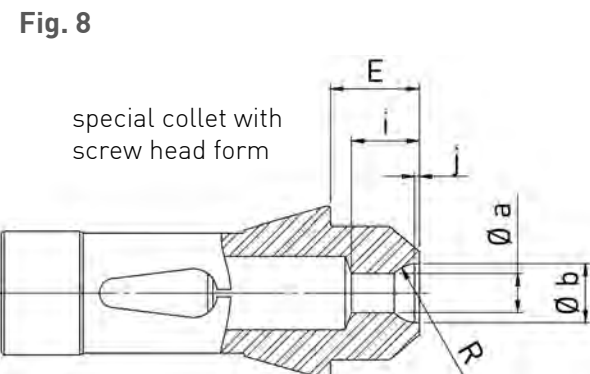
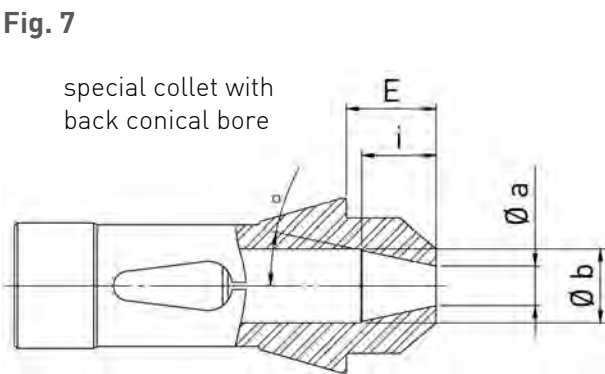
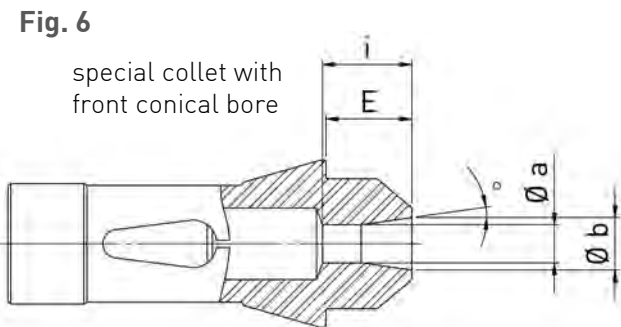
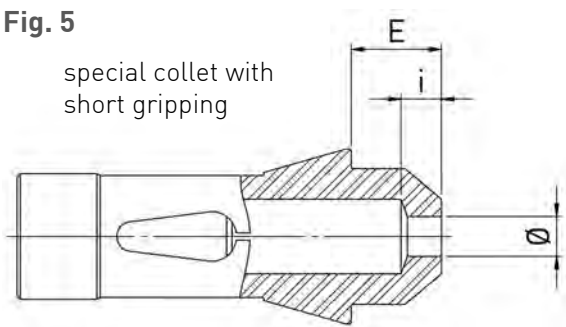

☐ Short nose
 ☐ with key way on shank
 ☐ with key way on conus

☐ Long nose

☐ Steel

☐ Carbide bore

Fig. n°

Collet type :

Qty :

Ø =

Ø a =

Ø b =

Ø c =

E =

i =

j =

k =

° =

R =

l =

h =

d =